



## Your benefits with Deltech® filters

Easy maintenance: snap up filter elements (9 - 750)

Operational reliability: high quality components

Energy saving: low pressure drop

Problem free application: silicone free

Standard models of the Deltech® GF, PF, HF, DF and CF filters		GF	PF	HF	DF	CF	9 - 36	54 - 216	285 - 750	810-10125
Medium	: Compressed air	•	•	•	•	•	•	•	•	•
Differential Pressure Indication	: Pop-up indicator	•	•	•	•	-	•	-	-	-
	Differential Pressure Gauge	•	•	•	•	-	-	•	•	•
	Differential Pressure Gauge with potential free alarm contact	○	○	○	○	-	-	○	○	○
Housing	: Aluminium	•	•	•	•	•	•	•	•	-
	Steel bowl	○	○	○	○	○	-	-	○	-
	Steel, lube-resistant	○	○	○	○	○	-	-	-	○
Condensate drain	: Automatic float drain	•	•	•	-	-	•	•	•	-
	Timer controlled drain valve	○	○	○	-	-	○	○	○	•
	Level controlled electronic drain valve	○	○	○	-	-	○	○	○	○
	Manual drain	-	-	-	•	•	•	•	•	•
Colour	: RAL 9001 (white)	•	•	•	•	•	•	•	•	•
Filtration efficiency	: 99.9% of particles at 10 μ	•	-	-	-	-	•	•	•	-
	99.999% of particles at 1 μ	-	•	-	•	-	•	•	•	•
	99.999% of particles at 0.01 μ	-	-	•	-	-	•	•	•	•
Residual oil content at 20°C	: 0.5 mg/m <sup>3</sup>	-	•	-	-	-	•	•	•	•
	0.01 mg/m <sup>3</sup>	-	-	•	-	-	•	•	•	•
	0.003 mg/m <sup>3</sup>	-	-	-	-	•	•	•	•	•
Location	: Indoors	•	•	•	•	•	•	•	•	•
IP rating	: IP 65	•	•	•	•	•	-	-	-	•
Vessel code	: CE	•	•	•	•	•	-	-	-	•
	Different vessel codes	○	○	○	○	○	-	-	-	○

• standard  
○ optional  
- not applicable

Design data	minimum	design	maximum	GF	PF	HF	DF	CF
Inlet pressure	2 bar(g)	7 bar(g)	16 bar(g)	•	•	•	•	•
Ambiant temperature	+2°C	-	+55°C	•	•	•	•	•
Operation temperature	+2°C	-	+65°C	•	•	•	-	•
	+2°C	-	+80°C	○	○	○	•	○

\* Use the multipliers when the conditions are different from standard. Refer to the table on the other side of this page.

Flair also issues a computer program capable of making the selection for you.

Deltech® GF filters  
 Deltech® PF filters  
 Deltech® HF filters

Filtration degree: 10 µ  
 Filtration degree: 1 µ  
 Filtration degree: 0.01 µ

Model	Capacity 1 bar a, 20°C m³/h	Connection		Dimensions					Weight		Filter element		
		in- and outlet	drain	A mm	B mm	C mm	D mm	E mm	kg	GF	PF	HF	Qty
9	30	1/4" BSP	-	86	230	63	90	-	1.0	GFD 9	PFD 9	HFD 9	1
18	60	3/8" BSP	-	86	230	63	90	-	1.0	GFD 18	PFD 18	HFD 18	1
36	120	1/2" BSP	-	86	279	63	90	-	1.1	GFD 36	PFD 36	HFD 36	1
54	180	3/4" BSP	-	114	330	86	120	-	2.4	GFD 54	PFD 54	HFD 54	1
90	300	1" BSP	-	114	443	86	120	-	2.7	GFD 90	PFD 90	HFD 90	1
135	450	1 1/2" BSP	-	146	412	92	150	-	5.0	GFD 135	PFD 135	HFD 135	1
216	720	1 1/2" BSP	-	146	533	92	150	-	5.5	GFD 216	PFD 216	HFD 216	1
285	950	2" BSP	-	178	557	111	180	-	11.0	GFD 285	PFD 285	HFD 285	1
405	1350	2" BSP	-	178	748	111	180	-	13.0	GFD 405	PFD 405	HFD 405	1
540	1800	3" BSP	-	206	880	128	200	-	18.0	GFD 540	PFD 540	HFD 540	1
750	2500	3" BSP	-	206	1007	128	200	-	20.0	GFD 750	PFD 750	HFD 750	1
810	2700	DN100	3/8"	900	460	1245	220	800	90	-	8113 PFD	8113 HFD	2
1215	4050	DN100	3/8"	900	520	1260	273	800	130	-	8113 PFD	8113 HFD	3
1620	5400	DN150	3/8"	930	570	1330	324	800	160	-	8113 PFD	8113 HFD	4
2025	6750	DN150	3/8"	930	570	1330	324	800	160	-	8113 PFD	8113 HFD	5
2430	8100	DN150	3/8"	930	610	1335	356	800	210	-	8113 PFD	8113 HFD	6
3645	12150	DN200	3/8"	960	720	1415	457	800	320	-	8113 PFD	8113 HFD	9
5265	17550	DN250	3/8"	985	770	1475	508	800	450	-	8113 PFD	8113 HFD	13
6480	21600	DN250	3/8"	985	870	1495	610	800	620	-	8113 PFD	8113 HFD	16
7290	24300	DN250	3/8"	985	870	1495	610	900	620	-	8113 PFD	8113 HFD	18
10125	33750	DN300	3/8"	1015	980	1600	711	950	800	-	8113 PFD	8113 HFD	25

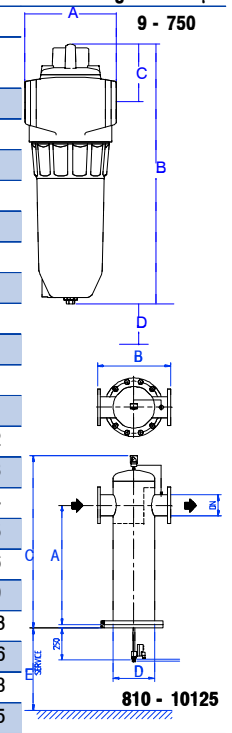

Deltech® DF filters  
 Deltech® CF filters

Filtration degree: 1 µ  
 Remove: Oil vapour and Odour

Model	Capacity 1 bar a, 20°C m³/h	Connection		Dimensions					Weight		Filter element			
		in- and outlet (BSP)	drain	A mm	B mm DF	C mm CF	D mm DF	E mm CF	mm	mm	kg	DF	CF	qty
9	30	1/4" BSP	-	86	239	206	63	31	90	-	1.0	DFD 9	CFD 9	1
18	60	3/8" BSP	-	86	239	206	63	31	90	-	1.0	DFD 18	CFD 18	1
36	120	1/2" BSP	-	86	288	256	63	31	90	-	1.1	DFD 36	CFD 36	1
54	180	3/4" BSP	-	114	339	306	86	53	120	-	2.4	DFD 54	CFD 54	1
90	300	1" BSP	-	114	452	419	86	53	120	-	2.7	DFD 90	CFD 90	1
135	450	1 1/2" BSP	-	146	421	388	92	59	150	-	5.0	DFD 135	CFD 135	1
216	720	1 1/2" BSP	-	146	542	509	92	59	150	-	5.5	DFD 216	CFD 216	1
285	950	2" BSP	-	178	566	533	111	78	180	-	11.0	DFD 285	CFD 285	1
405	1350	2" BSP	-	178	757	725	111	78	180	-	13.0	DFD 405	CFD 405	1
540	1800	3" BSP	-	206	905	872	128	96	200	-	18.0	DFD 540	CFD 540	1
750	2500	3" BSP	-	206	1032	999	128	96	200	-	20.0	DFD 750	CFD 750	1
810	2700	DN100	3/8"	900	460	1245	220	800	90	8113 DFD	8113 CFD	2		
1215	4050	DN100	3/8"	900	520	1260	273	800	130	8113 DFD	8113 CFD	3		
1620	5400	DN150	3/8"	930	570	1330	324	800	160	8113 DFD	8113 CFD	4		
2025	6750	DN150	3/8"	930	570	1330	324	800	160	8113 DFD	8113 CFD	5		
2430	8100	DN150	3/8"	930	610	1335	356	800	210	8113 DFD	8113 CFD	6		
3645	12150	DN200	3/8"	960	720	1415	457	800	320	8113 DFD	8113 CFD	9		
5265	17550	DN250	3/8"	985	770	1475	508	800	450	8113 DFD	8113 CFD	13		
6480	21600	DN250	3/8"	985	870	1495	610	800	620	8113 DFD	8113 CFD	16		
7290	24300	DN250	3/8"	985	870	1495	610	900	620	8113 DFD	8113 CFD	18		
10125	33750	DN300	3/8"	1015	980	1600	711	950	800	8113 DFD	8113 CFD	25		

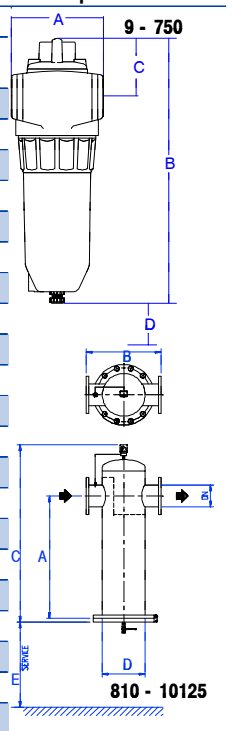

Filter element	GF	PF	HF	DF	CF
Initial pressure drop (dry)	0.03	0.03	0.08	0.03	0.03
Initial pressure drop (wet)	-	0.14	0.19	-	-
Element change-out at	0.40	0.40	0.40	0.40	-
Colour	transparent	green	blue	red	silver

Multiplier for different inlet pressures in bar(g)	2	3	4	5	6	7	8	9	10	11	12	13	14	15	16
Multiplier 9 - 750	0.40	0.50	0.62	0.75	0.87	1.00	1.12	1.25	1.37	1.50	1.62	1.75	1.87	2.00	2.12
Multiplier 810 - 10125	0.71	0.79	0.87	0.93	1.00	1.06	1.12	1.17	1.22	1.27	1.31	1.37	1.41	1.46	

Subject to alteration without prior notice

DS-F2000-1001-EN

ART.NR. 8650012

**Flair Filtration & Drying BV**  
 Heistraat 1  
 4878 AJ Etten-Leur  
 the Netherlands  
 Tel.: (+31) 076 - 5085800  
 Fax: (+31) 076 - 5085590  
 email: info@flairbv.nl

Your Flair distributor is:



a FLAIR company